

Handling bulk bags

Make sure bulk bags are in good condition and free of cuts and tears before loading or unloading, as any damage may compromise structural integrity. Always use a special lifting attachment to load or unload bulk bags. Do not use forklift tines on single loop bags. Ensure lifting equipment has smooth, rounded edges to avoid damaging the lifting loop. Ensure the lifting attachment is secured to the lifting device as per the manufacturer's instructions. Check the load rating of the lifting attachment and the lifting device by referring to load rating plates. Do not exceed the lifting capacity of the attachment or lifting device being used. Ensure no-one is standing beneath or close to the load when it is being lifted, moved or emptied. The lift should be smooth and vertical. Complete the transfer – do not leave the load hanging in the air. Provide training and supervision in the use of the attachment as necessary. Visit www.swa.gov.au for more information regarding forklift and other lifting devices safety.

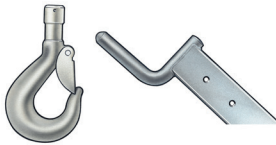

Bulk bags should be lifted with a lifting hook



The lifting hook should have well-rounded edges



Do not use a pallet fork



Use a long-handled knife to cut the bag.

Emptying bulk bags safely

Empty bulk bags by making two crossed incisions (approx. 30 to 40 cm) in the middle of the underside of the bag. Use a long-handled knife to cut the bag. Never walk under a suspended bag.



Knowledge grows

Handling and transport guidelines for bulk bags.

Yara is committed to ensuring everyone in the fertiliser supply chain takes proper care to ensure their health and safety, as well as protecting the environment and food safety. Visit yara.com.au for more information about the safe handling and transport of bulk bags.

Yara Australia Pty. Ltd.
Level 1, 6 Holt St
McMahons Point NSW 2060

Toll Free: 1800 684 266
Email: au.sales@yara.com



Transporting bulk bags

Block forwards

Containing bulk bags can be an effective form of restraint. Load bulk bags in groups without gaps and block in the forwards direction.

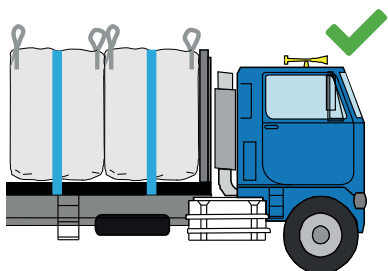

Block bulk bags forwards

Split loads

Split full loads into multiple groups to reduce the load on each blocking surface. Apply a minimum of one webbing strap to every row and two webbing straps to the final row of each group. Additional straps may be required depending on the weight of the load.

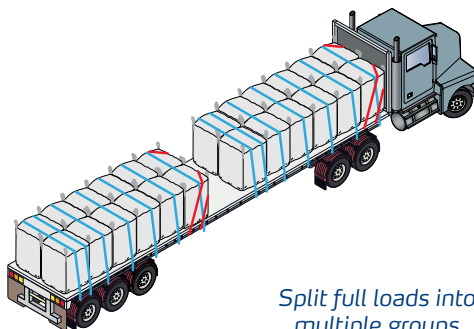

Split full loads into multiple groups

During transport

Lashings may become loose during transport as the load settles. Check lashing tensions at regular intervals during transport and re-tighten as required.

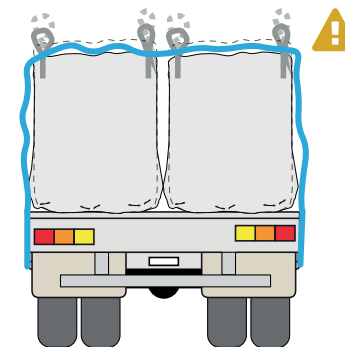

Check lashing tensions

Reinforce unrated blocking surfaces

Reinforce unrated blocking surfaces using chains (or similar) wrapped across the face of the blocking surface. Pass reinforcing chains through a hollow section welded to the blocking surface. Note that unrated blocking surfaces, even if reinforced, may fail if used improperly.

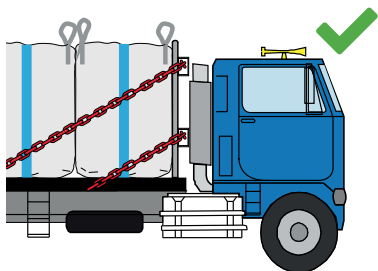

Reinforce unrated headboards

Crossover strap tension

Where a suitably engineered blocking surface is not available, block bags with crossover straps angled at a maximum of 45° to the horizontal. Tension crossover straps using in-line ratchets. Do not use drum winches to tension crossover straps.

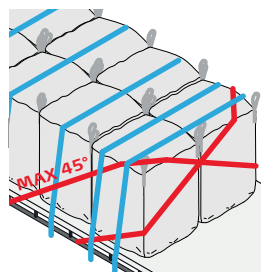

Block bags with crossover straps

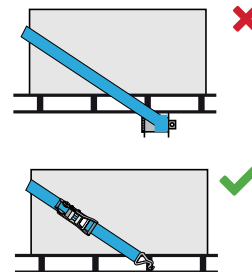

Tension crossover straps

Visit the [National Transport Commission website \(www.ntc.gov.au\)](http://www.ntc.gov.au) for more information about restraining bulk bags.

Personal safety

Always take care to protect yourself from harm when handling a chemical product, regardless of whether the product is classified as hazardous or not. Avoid direct contact with skin and eyes. Always read the label on the package. It contains important information on the potential hazards and how to minimise the associated risks. Detailed health and safety information is provided in the product Safety Data Sheet, which can be found on the Yara website.